

Summary of the documentation

EASYBUILD- CONSTRUCTION MANUAL

Desktop CNC-/3D-System STEPCRAFT 300 CK / 420 CK



original construction manual
date from 09.05.2013

Listing of all parts and illustration of selected components true to scale

Content of the construction kit (illustrations are not true to scale)

1

portal site part (right),
orange-coated
aluminium

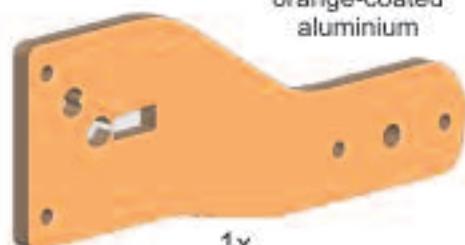

1x

2

portal site part (left),
orange-coated
aluminium

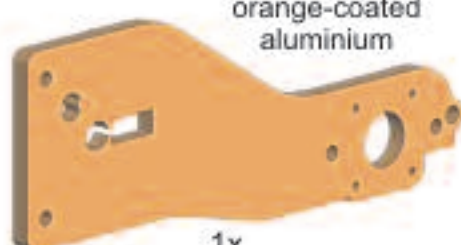

1x

3

tool holder,
orange-coated
aluminium



1x

4

front panel,
orange-coated
aluminium

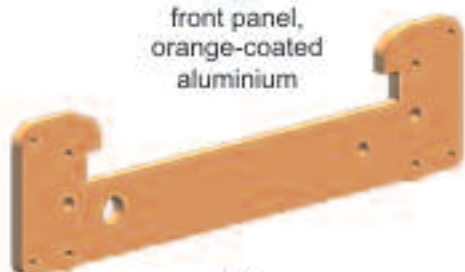

1x

5

rear panel,
orange-coated
aluminium

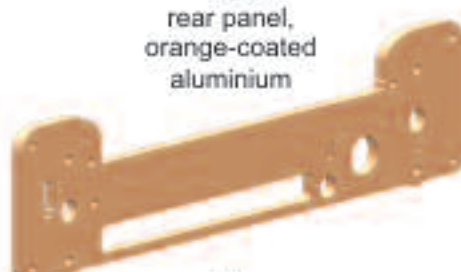

1x

6

X-Z-connector,
orange-coated
aluminium



1x

7

front panel (table fixing),
orange-coated
aluminium



1x

8

motor holder Z,
orange-coated
aluminium



1x

9

linear track X-axis,
extruded aluminium profile anodized



1x

71

motor X-/ Z-axis
Nanotec

2x

72

motor Y-Achse
Nanotec

1x

73

X-Z end switch
connector cable

1x

74

X-Z connector cable



1x

75

Y end switch/
emergency
connector cable

2x

76

flexible hose,
ø7,4mmS300=490mm/ S420=570mm
1x

77

flexible hose,
ø12mmS300=500mm/ S420=620mm
1x

78

clamping system,
grey-coated,
steel panel

2x

79

end switch for
X-, Y- and Z-axis

3x

80

closing cap,
rubber

1x

81

tool holder adapter,
ø43mm/ø20mm,
aluminium1x
optional accessory

1:1 true to scale comparison illustrations:

23



washer for M3

30



M3x12

33



M3x14

24



washer for M4

31



M3x30

34



M3x20

25



washer for M5

32



M4x25

35



M5x16

26



washer for M6

37



M6x8

36



M6x20

27



washer for M8

38



M8x8

40



M3x4

29



M3x6

39



M8x20

41



M4x4



Step-by-step manual with chronological numbered instructions and graphical illustrations of the particular intermediate result

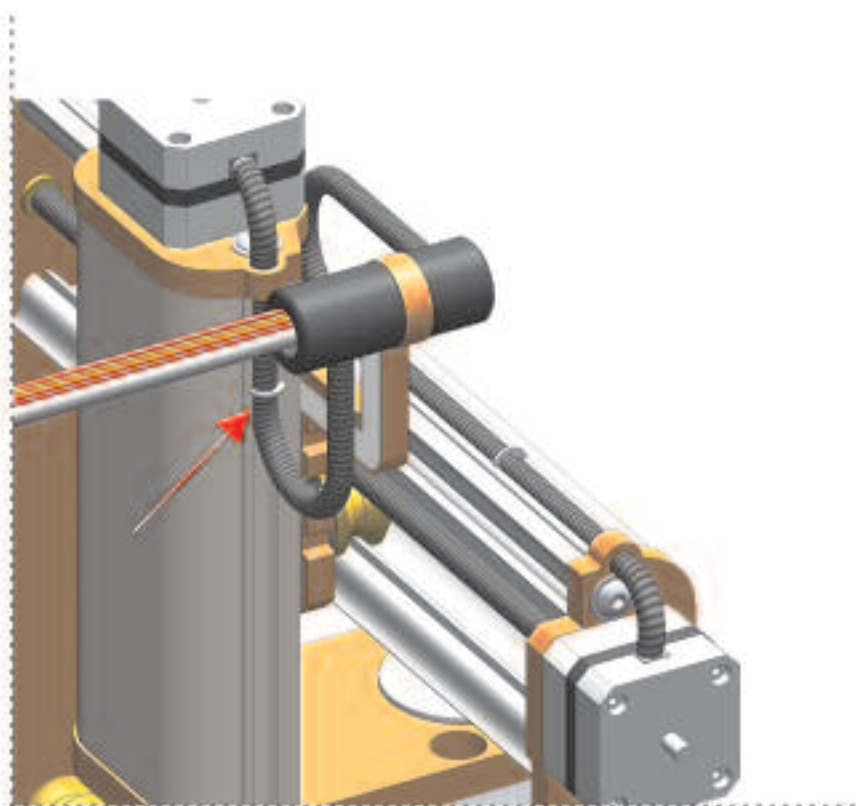

E

end switch Y-axis

E.1

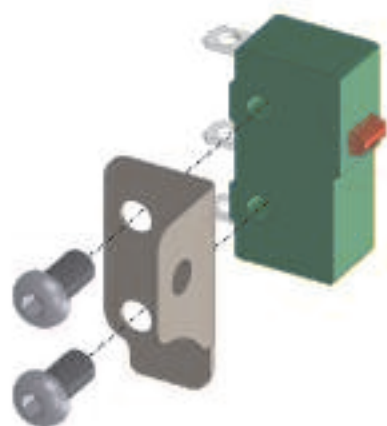

28
1x



29
2x



M3x6

79
1x

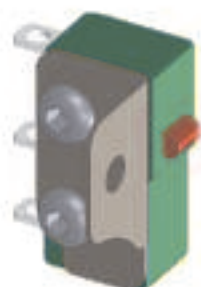

4



machine table and final assembly

4.1

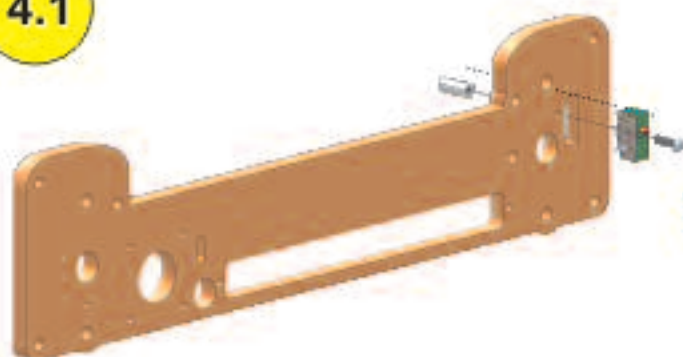

5
1x



30
1x



M3x12

44
1x



E
1x

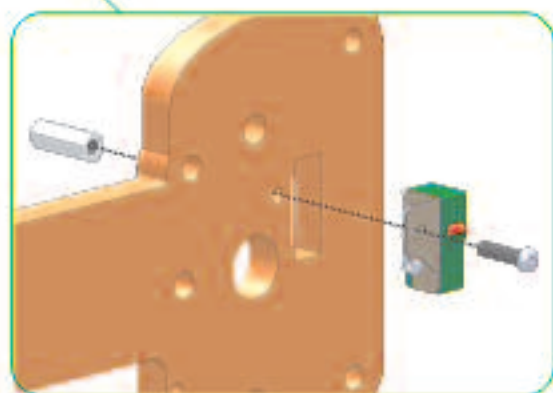
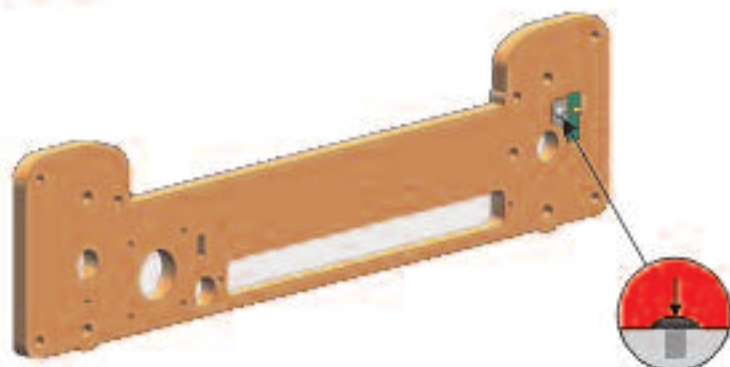

4.2

- 19 2x
- 24 1x for M4
- 32 1x M4x25
- 43 1x M4
- 45 1x

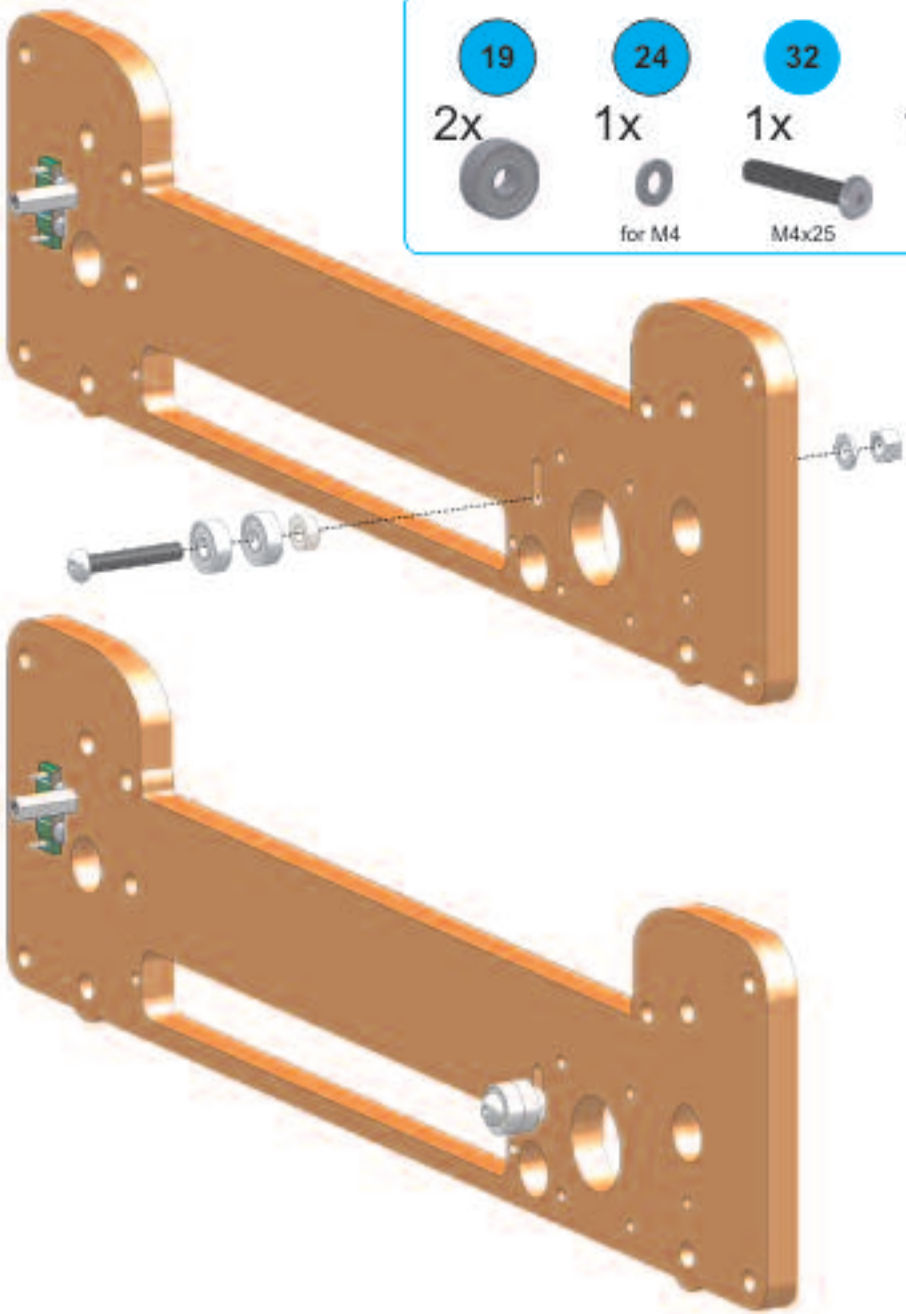

F

F.1

- 40 1x M3x4
- 52 1x
- 72 1x

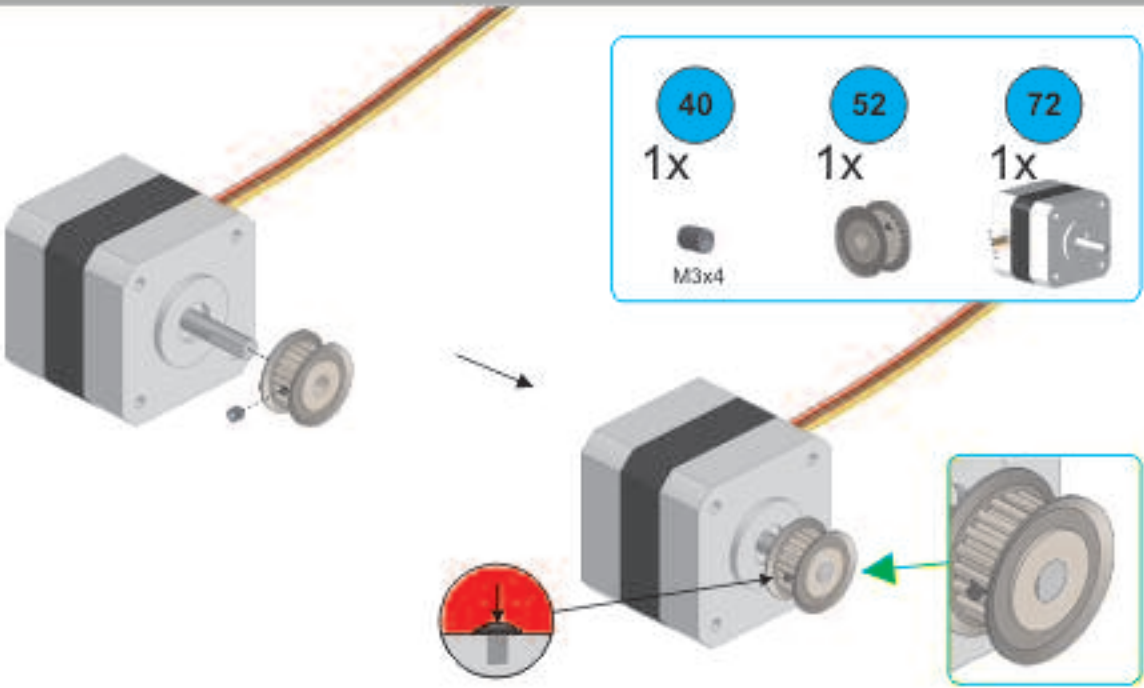

Wiring diagram

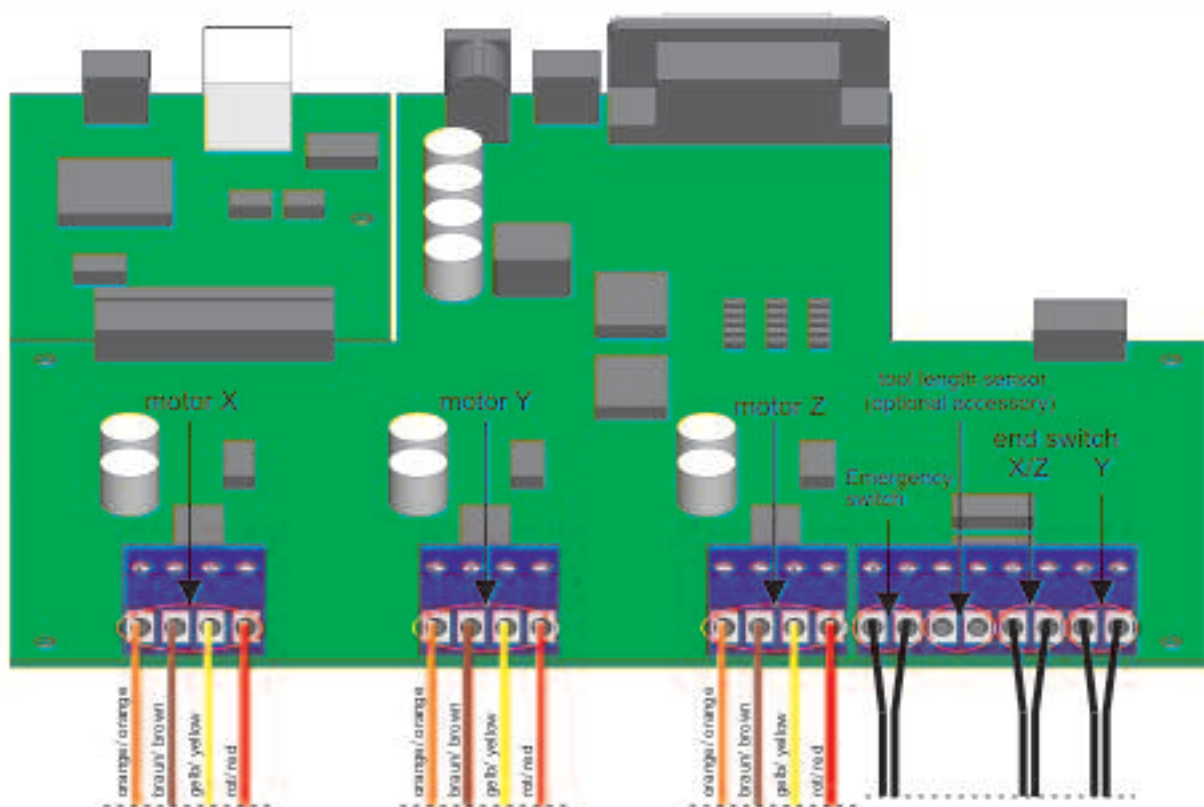

5.5

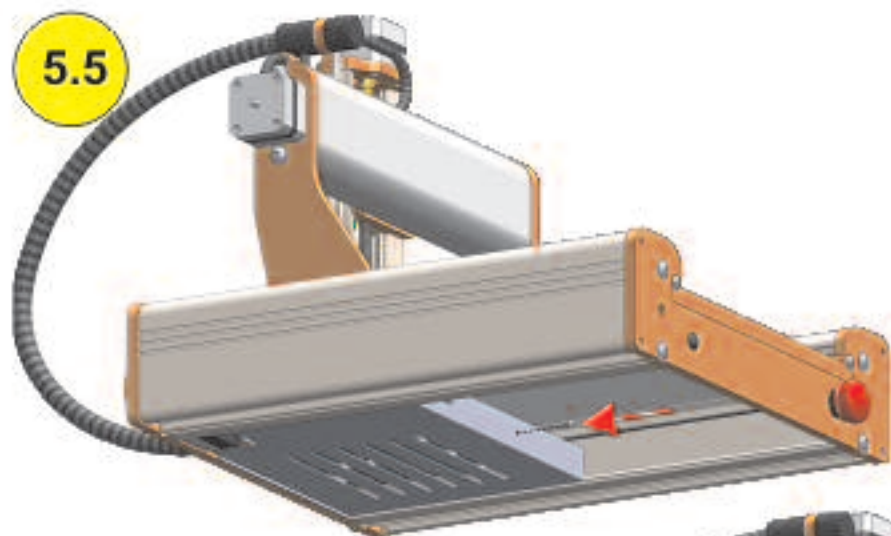

29

1x



M3x6

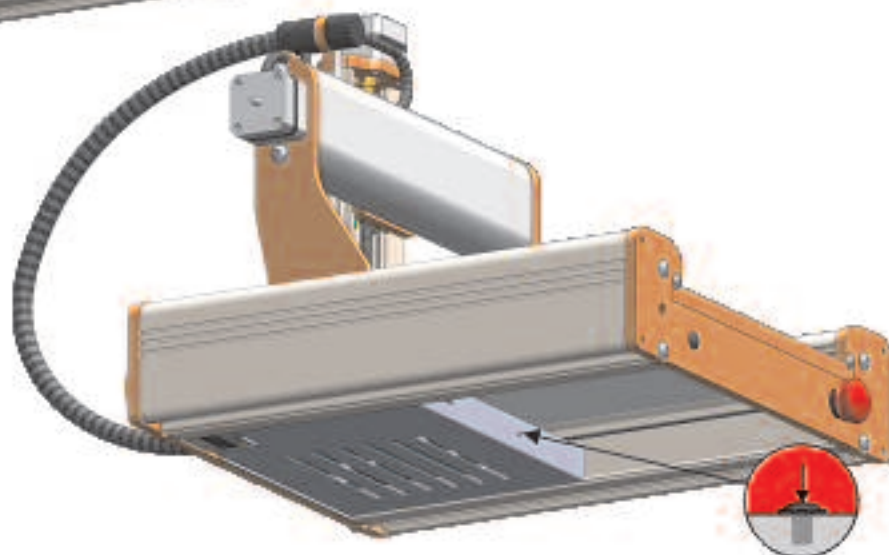

Maintenance schedule

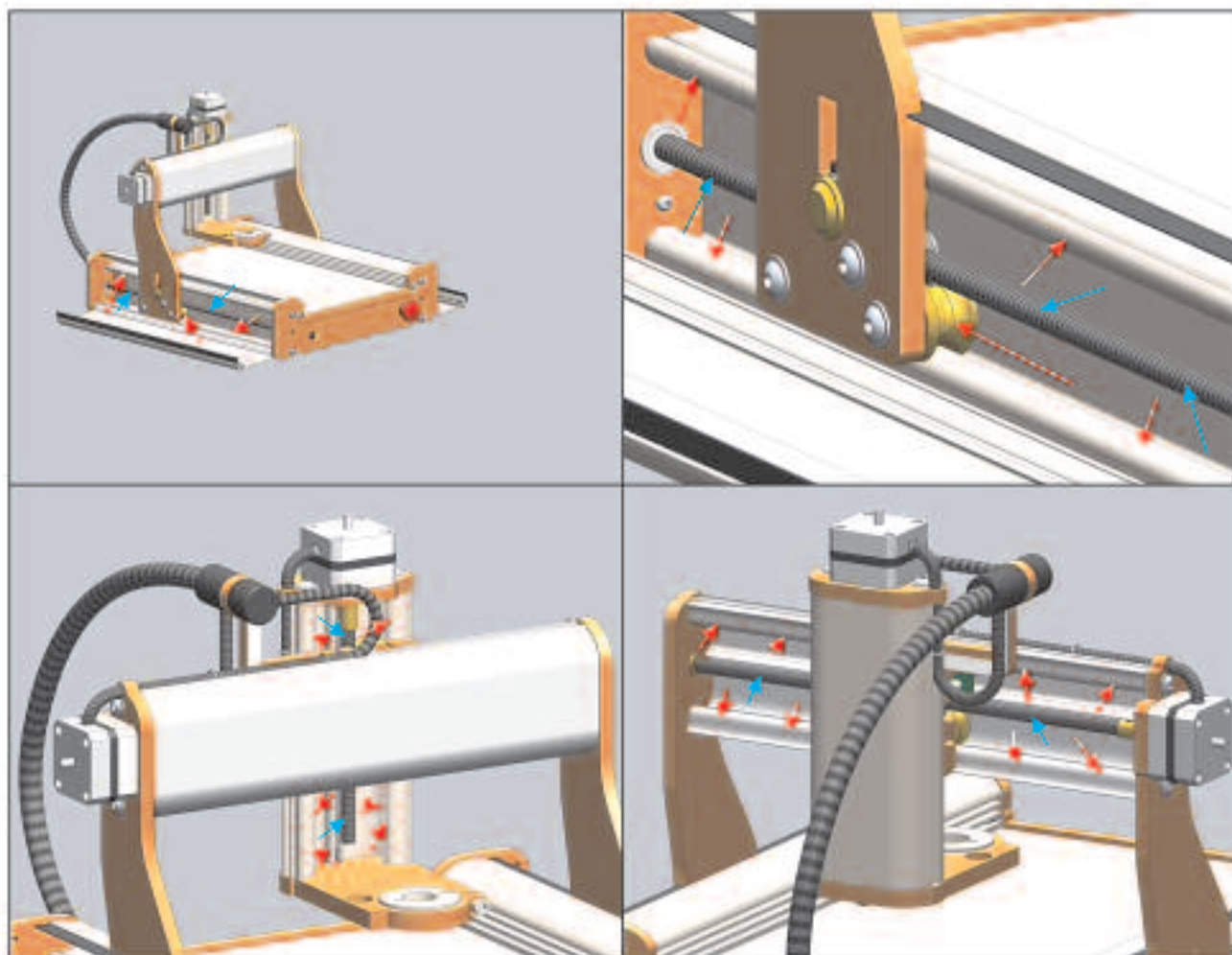

red marking:

1. All guide areas have to be adequately greased before the machine can be put into service
2. After two operating hours wipe the guide area clean and apply grease again
3. Repeat step 2 every 10 hours

blue marking:

Apply sewing machine oil on the threaded spindle. Clean it occasionally and apply oil again.